

CENTRAL PNEUMATIC®

GRAVITY FEED PAINT SPRAY GUN

Model 96382

ASSEMBLY AND OPERATION INSTRUCTIONS



Due to continuing improvements, actual product may differ slightly from the product described herein.



3491 Mission Oaks Blvd., Camarillo, CA 93011

Visit our website at: <http://www.harborfreight.com>

**TO PREVENT SERIOUS INJURY, READ AND UNDERSTAND
ALL WARNINGS AND INSTRUCTIONS BEFORE USE.**

Copyright© 2007 by Harbor Freight Tools®. All rights reserved. No portion of this manual or any artwork contained herein may be reproduced in any shape or form without the express written consent of Harbor Freight Tools.

For technical questions or replacement parts, please call 1-800-444-3353.

Specifications

Nozzle Size	1.4mm
Air Inlet Size	1/4-18 NPS
Recommended Hose	3/8"
Required Pressure	40 - 50 PSI
Air Consumption	4->6 SCFM During Operation
Cup Size	20 Ounces
Weight	1.2 Pounds

Save This Manual

You will need the manual for the safety warnings and precautions, assembly instructions, operating and maintenance procedures, parts list and diagram. Keep your invoice with this manual. Write the invoice number on the inside of the front cover. Keep the manual and invoice in a safe and dry place for future reference.

SAFETY WARNINGS AND PRECAUTIONS

WARNING: When using tool, basic safety precautions should always be followed to reduce the risk of personal injury and damage to equipment.

1. **Keep work area clean.** Dark and cluttered areas invite injuries.
2. **Observe work area conditions.** Do not use this tool in damp or wet locations. Do not expose to rain.
3. **Keep children away.** Children must never be allowed in the work area. Never let them handle the Spray Gun.
4. **Store idle equipment.** When not in use, this tool must be stored in a dry location to inhibit rust. Always lock up tools and keep out of reach of children.
5. **Do not force this tool, it will do the job better and more safely at the rate for which it was intended.** Do not use inappropriate attachments in an attempt to exceed the tool capacity.
6. **Use the right tool for the job.** Do not attempt to force a small tool or attachment to do the work of a larger industrial tool. There are certain applications for which this tool was designed; do not modify this tool and do not use this tool for a purpose for which it was not intended.
7. **Dress properly.** Do not wear loose clothing or jewelry. Protective, electrically non-conductive clothes and non-skid footwear are recommended when working. Wear restrictive hair covering to contain long hair.
8. **Use eye and ear protection.** Always wear ANSI approved chemical splash safety goggles.
9. **Use breathing protection.** Wear an OSHA or NIOSH approved dual-filter dust mask or respirator mask when working around chemical dusts and paint mists. Be sure

the mask fits properly. Beards and facial hair may keep masks from sealing properly. Change filters often. Disposable paper masks are not adequate.

10. **Do not overreach.** Keep proper footing and balance at all times. Do not reach over or across running machines.
11. **Maintain this tool with care.** Keep tools clean for better and safer performance. Follow instructions for lubricating and changing accessories. Inspect tool cords periodically and, if damaged, have them repaired by an authorized technician. The handles must be kept clean, dry, and free from paint at all times.
12. **Stay alert.** Watch what you are doing, and use common sense when operating any tool. Do not use this tool while tired or under the influence of drugs, alcohol, or medication. A moment of inattention while operating a tool can result in serious personal injury.
13. **Check for damaged parts.** Check for alignment and binding of moving parts, broken parts, leaks, or damaged mounting fixtures, and any other condition that may affect proper operation. Any part that is damaged should be properly repaired or replaced by a qualified technician. Do not use the tool if the Trigger (26) does not turn it On and Off properly.
14. **Replacement parts and accessories.** When servicing, use only identical replacement parts. Use of any other parts will void the warranty. Only use accessories intended for use with this tool.
15. **Clean sprayer with care.** Use nonflammable solvents.
16. **Avoid fire danger.** Do not smoke while using the Spray Gun. Never spray near open flames, pilot lights, stoves, heaters, or any other heat source. Most solvents and coatings are highly flammable, particularly when spraying. The work area must always have adequate ventilation.
17. **Read all information concerning coating products.** Chlorinated solvents (1-1-1 Trichlorethylene and Methylene Chloride, also known as Methyl Chloride) can chemically react with aluminum and may explode. Many paint sprayers contain aluminum. If you have any doubt about potential chemical reactions, contact the solvent or coating manufacturer.
18. **Materials used when painting or cleaning may be harmful or fatal if inhaled or swallowed.** Use a respirator or mask when painting or using cleaning solvents.
19. **Use only in well-ventilated areas.**
20. **Never release the sprayer lid while the cup is pressurized.** The paint could burst out and contaminate your body or cause other property damage or personal injury.
21. **Be aware of other people and animals.** Do not use the sprayer near children or animals. Keep all visitors away from the work area. Do not let children or visitors handle tools.
22. **Industrial applications must follow OSHA requirements.**

23. **Be aware of air hoses and connections.** Take care to not trip over hoses. Make sure all connections are tight and air hoses are properly rated.
24. **Maintenance.** For your safety, maintenance should be performed regularly by a qualified technician.

Warning: The warnings, cautions, and instructions discussed in this instruction manual cannot cover all possible conditions and situations that may occur. It must be understood by the operator that common sense and caution are factors which cannot be built into this product, but must be supplied by the operator.

UNPACKING

When unpacking, check to make sure that all the parts are included. (See the Parts List and Assembly Drawing at the end of this manual.) If any parts are missing or broken, please call Harbor Freight Tools at the number on the cover of this manual as soon as possible.

ASSEMBLY

For best results, a regulator should be connected to the Spray Gun, as shown below.

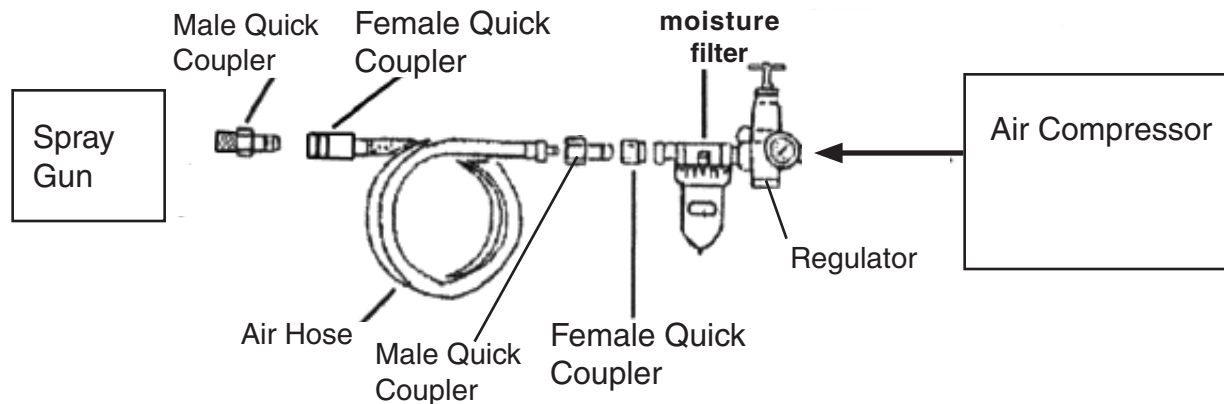

1. Clean the sprayer out by flushing with a nonflammable solvent.
2. Check all seals before connecting to the air supply.
3. Slide the Paint Cup Gasket (28) over the Cup Connector (27) and place the Filter (29) in the Cup Connector.
4. Screw the Paint Cup (30) onto the Cup Connector (27) and tighten firmly.
5. Connect a 3/8" air hose with a connection compatible to 1/4-18 NPS to the air compressor air outlet.
6. While holding the open end of the air supply hose, momentarily turn on the compressor air to clean out any debris within the hose.
7. Connect the air supply hose to the Air Connector (21).

OPERATION

Filling and Adjusting the Air Spray Gun

1. Remove the cover of the Paint Cup (30) and fill with the paint to be sprayed.
2. Replace and tighten the cup's cover.
3. Prepare a spraying test area.
4. Turn on the air supply and adjust the air regulator on the compressor to no more than 50 PSI.
5. Point the Spray Gun in the direction of the spray test area and press the Trigger (26).
6. Adjust the spray pattern (horizontal or vertical) by turning the Air Cap (1).
7. Adjust the air-to-material mixture by adjusting the Air Adjusting Valve (20).
8. Adjust the spray width using the Fan Adjustment Valve (18). Do not unscrew completely.
9. Adjust the amount of paint flow by using the Fluid Valve (10).

Paint Preparation

Verify the percentage of paint thinning required for use with a HVLP (High Volume, Low Pressure) Spray Gun, with the paint or materials supplier. Try thinning a small amount and testing the spray action. Thoroughly mix material before testing.

Spraying Techniques

1. Clean area with a mild detergent and allow to dry prior to beginning.
2. While spraying, move the Spray Gun in parallel strokes to the object being painted.
3. Keep 4 to 12 inches between the Spray Gun and the object being painted. This may be slightly different depending on the flow adjustment and the type of paint being sprayed.
4. Release the Trigger (26) at the end of each forward movement; Pull the Trigger again on the return movement.
5. When using a vertical pattern, move the Spray Gun in a horizontal motion; With a horizontal pattern, move the Spray Gun in a vertical motion. The round pattern requires a greater distance from the object being painted.

MAINTENANCE

The Spray Gun must be cleaned **immediately** after use. If the paint dries inside the Spray Gun, cleaning is much more difficult and the unit may be permanently damaged.

To clean the Spray Gun:

Caution: Do this procedure in a well ventilated area, away from flames.

1. Remove Spray Gun from air supply.
2. Remove the Paint Cup (30) from the Spray Gun.
3. Remove cup cover and pour any left-over paint into the paint container and seal it.
4. Pour nonflammable thinner or solvent into the Paint Cup, or if water-based paint was used, add water. Replace Lid.
5. Reattach the Paint Cup to the Spray Gun and shake the liquid inside vigorously.
6. Turn on the Air Supply and spray the liquid into a waste bucket.
7. Repeat this procedure until the spray output is free of paint.
8. Dispose of the waste solvent or thinner in a manner consistent with State, Local, and Federal regulations for the disposal of such waste materials.

Caution: Materials used when painting or cleaning may be harmful or fatal if inhaled or swallowed. Use only in an area with adequate ventilation. Use a respirator or mask when painting or using cleaning solvents. Do not use around flames.

PLEASE READ THE FOLLOWING CAREFULLY

THE MANUFACTURER AND/OR DISTRIBUTOR HAS PROVIDED THE PARTS LIST AND ASSEMBLY DIAGRAM IN THIS MANUAL AS A REFERENCE TOOL ONLY. NEITHER THE MANUFACTURER OR DISTRIBUTOR MAKES ANY REPRESENTATION OR WARRANTY OF ANY KIND TO THE BUYER THAT HE OR SHE IS QUALIFIED TO MAKE ANY REPAIRS TO THE PRODUCT, OR THAT HE OR SHE IS QUALIFIED TO REPLACE ANY PARTS OF THE PRODUCT. IN FACT, THE MANUFACTURER AND/OR DISTRIBUTOR EXPRESSLY STATES THAT ALL REPAIRS AND PARTS REPLACEMENTS SHOULD BE UNDERTAKEN BY CERTIFIED AND LICENSED TECHNICIANS, AND NOT BY THE BUYER. THE BUYER ASSUMES ALL RISK AND LIABILITY ARISING OUT OF HIS OR HER REPAIRS TO THE ORIGINAL PRODUCT OR REPLACEMENT PARTS THERETO, OR ARISING OUT OF HIS OR HER INSTALLATION OF REPLACEMENT PARTS THERETO.

PARTS LIST & ASSEMBLY DIAGRAM

Part	Description
1	Air Cap
2	Nozzle
3	Needle Packing Unit
4	Spring
5	Needle Packing Gasket
6	Gun Body
7	Needle
8	Needle Spring
9	Nozzle Adjusting Screw Cap
10	Fluid Valve
11	Air Valve Packing Screw
12	Gasket
13	Air Valve Seat
14	Air Valve Gasket
15	Air Valve Pole
16	Air Valve Spring
17	Fan Adjusting Valve Seat
18	Fan Adjusting Valve
19	Bolt
20	Air Adjusting Valve
21	Air Connector
22	Bolt
23	Trigger Connect
24	Trigger Stud
25	Needle Stud
26	Trigger
27	Cup Connection
28	Paint Cup Gasket
29	Filter
30	Paint Cup
31	Paint Brush (not shown)
32	Hex Spanner Wrench (not shown)

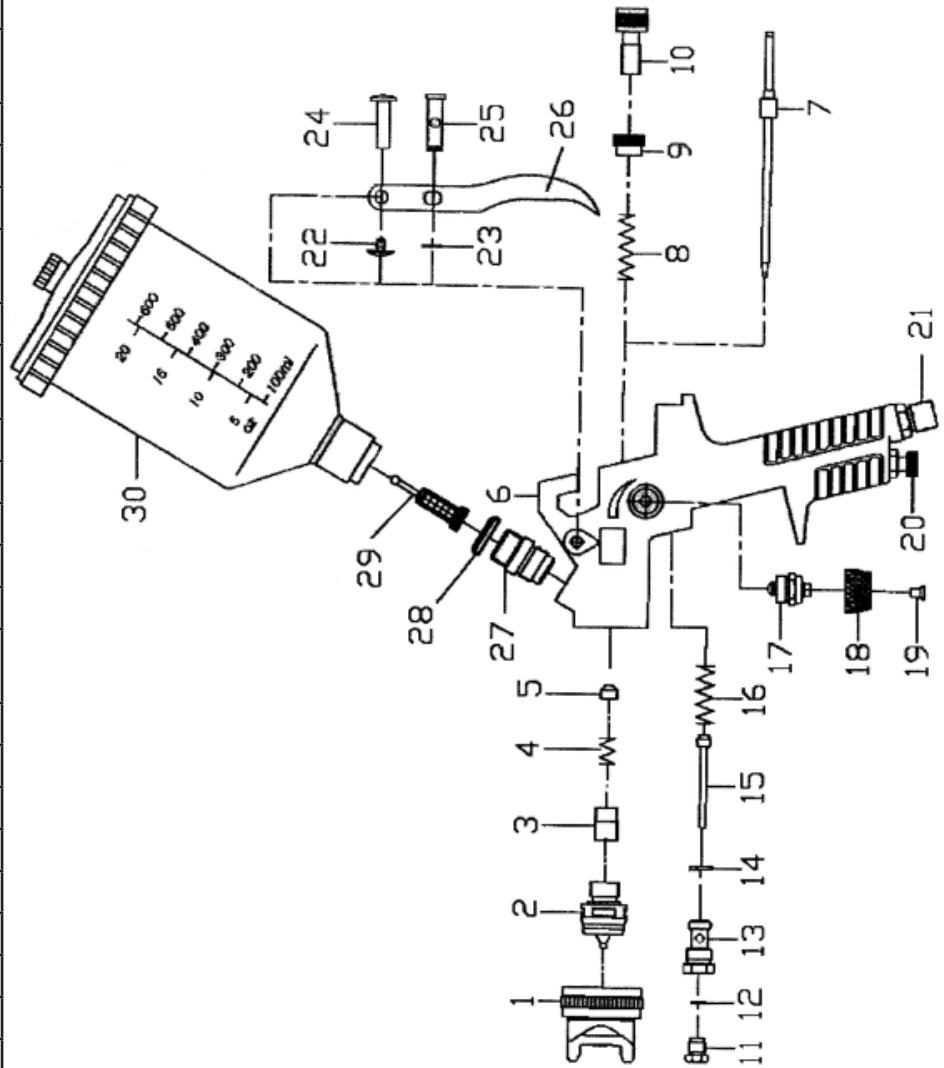

LIMITED 1 YEAR WARRANTY

Harbor Freight Tools Co. makes every effort to assure that its products meet high quality and durability standards, and warrants to the original purchaser that this product is free from defects in materials and workmanship for the period of one year from the date of purchase (90 days if used by a professional contractor or if used as rental equipment). This warranty does not apply to damage due directly or indirectly, to misuse, abuse, negligence or accidents, repairs or alterations outside our facilities, normal wear and tear, or to lack of maintenance. We shall in no event be liable for death, injuries to persons or property, or for incidental, contingent, special or consequential damages arising from the use of our product. Some states do not allow the exclusion or limitation of incidental or consequential damages, so the above limitation of exclusion may not apply to you. THIS WARRANTY IS EXPRESSLY IN LIEU OF ALL OTHER WARRANTIES, EXPRESS OR IMPLIED, INCLUDING THE WARRANTIES OF MERCHANTABILITY AND FITNESS.

To take advantage of this warranty, the product or part must be returned to us with transportation charges prepaid. Proof of purchase date and an explanation of the complaint must accompany the merchandise. If our inspection verifies the defect, we will either repair or replace the product at our election or we may elect to refund the purchase price if we cannot readily and quickly provide you with a replacement. We will return repaired products at our expense, but if we determine there is no defect, or that the defect resulted from causes not within the scope of our warranty, then you must bear the cost of returning the product.

This warranty gives you specific legal rights and you may also have other rights which vary from state to state.

3491 Mission Oaks Blvd. • PO Box 6009 • Camarillo, CA 93011 • (800) 444-3353

Record Product's Serial Number Here: _____

Note: If product has no serial number, record month and year of purchase instead.

Note: Some parts are listed and shown for illustration purposes only, and are not available individually as replacement parts.